

DUNE

LOT 6 FAIRTRADER DR

YAMBA



CONTENTS

3

SUMMARY

4

DESIGN

5

LOCATION

8

HIGHLIGHTS

9

INTERIORS

10

PLANS

12

CONTACT



A NEW FOUNDATION FOR REFINED BUSINESS

DUNE is more than a warehouse—it's a space where design meets purpose. Architecturally designed and inspired by coastal character of Yamba and Angourie, each space offers a refined, functional base that evolves with its owner. Whether you're growing a brand, storing with intention, or investing for the future, DUNE is purpose-built to suit your next move — and the one after that.



DESIGNED FOR THOSE WHO VALUE FORM AND FUNCTION

DUNE blends architectural strength with refined detail. Clean lines, warm textures, and premium finishes create spaces that feel as good as they perform. With natural light, robust materials, and thoughtful touches throughout, Dune is designed to elevate the everyday—built for those who expect more from where they work.





A LOCATION SHAPED BY LIFESTYLE

DUNE is set in one of the most desirable pockets of the Northern Rivers—on Fairtrader Drive in Yamba. Just a few minutes from the coast and within easy reach of the M1, it's a location that balances business with lifestyle. Whether you're fulfilling orders, launching a brand, or sneaking in a morning surf, DUNE places you at the intersection of ease and opportunity.





CRAFTED TO LAST. DESIGNED TO LEAD.

DUNE isn't just built—it's considered. From durable material to refined finishes, every element is chosen for both performance and presence. Whether you're scaling a growing business or creating something entirely new, DUNE offers a space that supports your ambition—and endures with it.

FEATURES

DURABLE CONCRETE TILT-PANEL CONSTRUCTION

FULLY APPROVED MEZZANINES

LED LIGHTING THROUGHOUT

SKYLIGHTS

CUSTOMISED FIT-OUTS AVAILABLE

NBN READY

DEDICATED PARKING ON TITLE

BATHROOMS WITH FLOOR-TO-CEILING TILES AND SHOWER

KITCHENETTE WITH OVERHEAD CABINETS

HIGH-CLEARANCE ELECTRIC ROLLER DOOR ACCESS

3 PHASE POWER AVAILABLE

OPTIONAL SOLAR BATTERY SYSTEM



INDUSTRIAL FORM. INTERIOR FINESSE.

Behind Dune's bold facade lies a considered interior—where function meet finish. Think full-height tiled bathrooms, stone-accented kitchenettes, and refined textures that elevate every detail. With natural light streaming through fluted glass and high-volume ceilings above, each space feels purposeful, polished, and ready to perform.



FLOORPLANS



UNIT	GROUND	MEZZ	TOTAL
1	90M ²	45M ²	135M ²
2	94M ²	30M ²	126M ²
3	94M ²	30M ²	126M ²
4	73M ²	46M ²	119M ²
5	70M ²	43M ²	113M ²
6	115M ²	69M ²	184M ²
7	103M ²	36M ²	139M ²
8	103M ²	36M ²	139M ²
9	82M ²	53M ²	135M ²
10	80M ²	52M ²	132M ²

FLOORPLANS



GROUND FLOOR

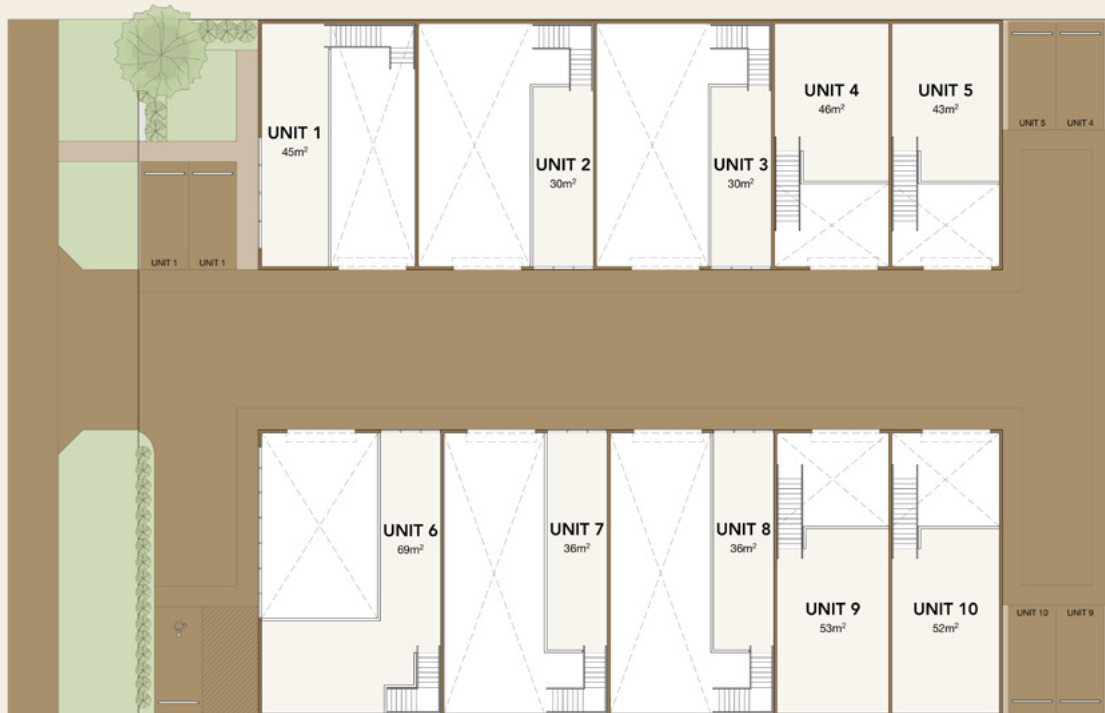

MEZZANINE FLOOR

SECURE YOUR SPACE AT DUNE

DUNE is proudly represented First National Yamba. To learn more about off-the-plan opportunities and secure your place in this architecturally created development, get in touch today—we'd be pleased to assist.



DAVID LOVELL
DIRECTOR / SALES

0417 606 728
DAVID@FNYAMBA.COM.AU

RICHARD HUNT
PRINCIPAL / SALES AGENT

0498 462 291
RICHARD@FNYAMBA.COM.AU



DUNE

DUNEYAMBA.COM.AU